

## Features of the WaterMax Range:

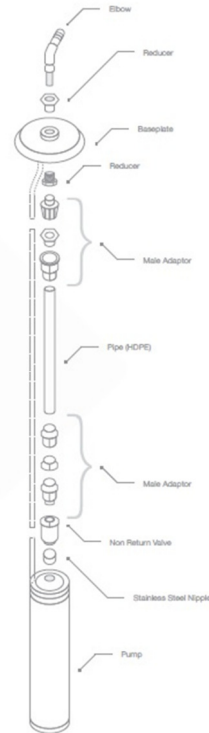

- A positive displacement submersible pump which is constructed of high quality bronze and stainless steel
- Spares are freely available
- Pumps are serviceable, clean and non-polluting
- Pumps are maintenance friendly
- Silent operation (therefore environmentally friendly)
- Can be moved from camp to camp as stock is rotated
- Ideal for homes, farms and livestock watering
- Can run on as little as 10 Watts of power
- Installed below the water in a borehole, lake, cistern or stream
- Repair kits are available
- Simplicity is the key feature
- It hangs from HDPE pipe (plastic)
- All accessories are non-corrosive
- Fitted with an equalizing diaphragm to compensate for submergence pressures, allowing early start-up and improving performance
- Used extensively by world renowned game parks in Africa
- Can run dry without water in the pump chamber
- Makes use of sealed bearings obtainable at any bearing dealer and thus does not need oil lubrication on any components which wear with time
- Running direct off the solar array without the use of batteries and complicated electronics
- Not susceptible to lightning strikes
- Maximum of 10 minutes to replace diaphragms
- Installation takes about 30 minutes



### Using a 220V power supply to operate the WaterMax in case of emergency:

The WaterMax can be run off a generating set or any other 220V AC power supply by using a WaterMax AC/DC Pumpmaster. The AC/DC Pumpmaster performs exactly the same functions as the Auto Pumpmaster, with the added capability to allow pumping from a 220V AC source.

### Warranty:

A 24 month warranty is applicable in South Africa. An international warranty is over a 12 month period.