

Applications

- Water supply
- Industry pressure boosting
- Industry liquid transfer
- Water treatment
- Irrigation

Motor

- Fitted with a totally enclosed fan-cooled, 2-pole motor
- Enclosure class: IP55
- Insulation class: F
- Supply voltage: 50Hz or 60Hz

Operation conditions

- Thin, clean, non-explosive liquids, not containing solid particles or fibers liquid
- Liquid temperature: normal temperature type: -15°C~+70°C hot water type: -15°C~+105°C
- Ambient temperature: maximum +40°C
- Altitude: maximum 1000m

Material

- Inlet&outlet chamber: Cast iron/Stainless steel(304/316)
- Impeller: Stainless steel(304/316)
- Shell: Stainless steel(304/316)
- Shaft: Stainless steel(304/316)
- Coupling: Ductile iron
- Bearing: Tungsten carbide
- Mechanical seal: Tungsten carbide/Graphite

Performance Curves

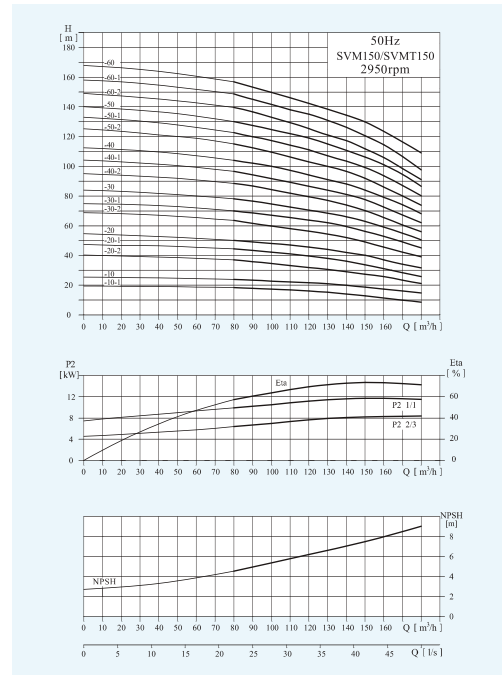

Performance Table

Model	Associated motor(kW)	Q (m³/h)	H (m)														
			80	90	100	110	120	130	140	150	160	170	180				
SVM150-10-1	11	H (m)	18.3	17.8	17.3	17	16	15	14	12.5	11	10	8.5				
SVM150-10	15		24	23	22.5	22	21.5	20.5	20	18.5	17	16	15				
SVM150-20-2	18.5		37	35.5	34	33	32	31	29	27.5	26	23	21				
SVM150-20-1	22		44.3	43	42	40	39	38.5	37.5	35	33	30	27				
SVM150-20	26		50	49	48	47	45.5	44	42	40	37	34	32				
SVM150-30-2	30		63.5	61	59	57.5	56	54.5	53	49	45.5	42	39				
SVM150-30-1	37		70	68	67	65	63	62	60	56	53	49	45				
SVM150-30	37		78	76.5	75	73	70.5	68	66	63	59	55	50.5				
SVM150-40-2	45		89	87	84	81.5	79	77	74.5	70.5	65.5	60	56				
SVM150-40-1	45		96.5	94	91.5	89	86.5	84	81.5	77	72.5	67	62				
SVM150-40	55		104	102	100	97	95	91	88	84	79.5	74	68				
SVM150-50-2	55		115.5	112	109	106	102.5	100	97	92	86	79	73.5				
SVM150-50-1	75		122.5	119.5	117	113.5	111.5	107.5	104.5	99	93.5	87	80				
SVM150-50	75		130	127.5	125	121	119	115	111.5	106.5	101	94.5	86.5				
SVM150-60-2	75		140	137	133	130	126	121	118	112	106	98	91				
SVM150-60-1	75		148.5	145	141.7	137.5	135	131	127	120.5	114.5	106.5	97.5				
SVM150-60	75		157	153	149	145	142	139.5	137	130	123.5	116	109				

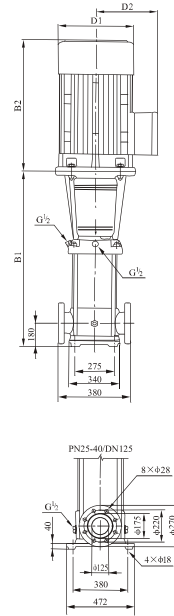

Dimension & Weight

Model	Size (mm)					Net Weight(kg)
	B1	B2	B1+B2	D1	D2	
SVM150-10-1	840	500	1340	330	255	230
SVM150-10	840	500	1340	330	255	235
SVM150-20-2	1000	550	1550	330	255	250
SVM150-20-1	1000	575	1575	360	285	295
SVM150-20	1000	575	1575	360	285	317
SVM150-30-2	1160	650	1810	400	310	360
SVM150-30-1	1160	650	1810	400	310	360
SVM150-30	1160	650	1810	400	310	385
SVM150-40-2	1320	685	2005	460	340	460
SVM150-40-1	1320	685	2005	460	340	460
SVM150-40	1350	760	2110	540	370	560
SVM150-50-2	1510	760	2270	540	370	570
SVM150-50-1	1510	845	2355	580	410	690
SVM150-50	1510	845	2355	580	410	690
SVM150-60-2	1670	845	2515	580	410	700
SVM150-60-1	1670	845	2515	580	410	700
SVM150-60	1670	845	2515	580	410	700