

DZA(S) FLANGED

Stub-shaft pump



Applications

The DZA range of flanged end suction pumps (according to DIN24255) are suitable for applications in irrigation, transfer and pressure boosting.

Pumped liquids include water containing >0.001kg/liter grit and liquids compatible with 304S/S.

Performance limits

Maximum working pressure:	10bar
Operating temperature range:	-20°C to +110°C
Mechanical seal construction:	Viton/Carbon/Sil.Carbide
Casing:	304S/S
Impeller:	304S/S
Shaft:	316L S/S

Symbols

Typical example:

DZA-65-40-160/4.0

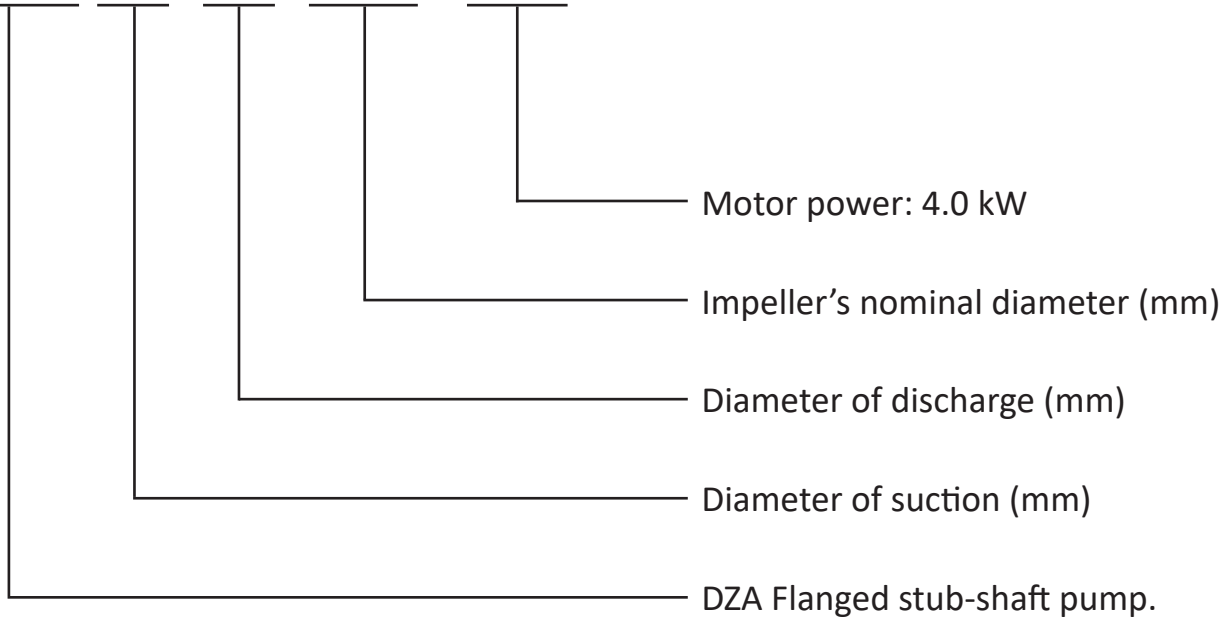

DZA(S)

1.1~9.2kW



Pump outline diagram & Dimensions

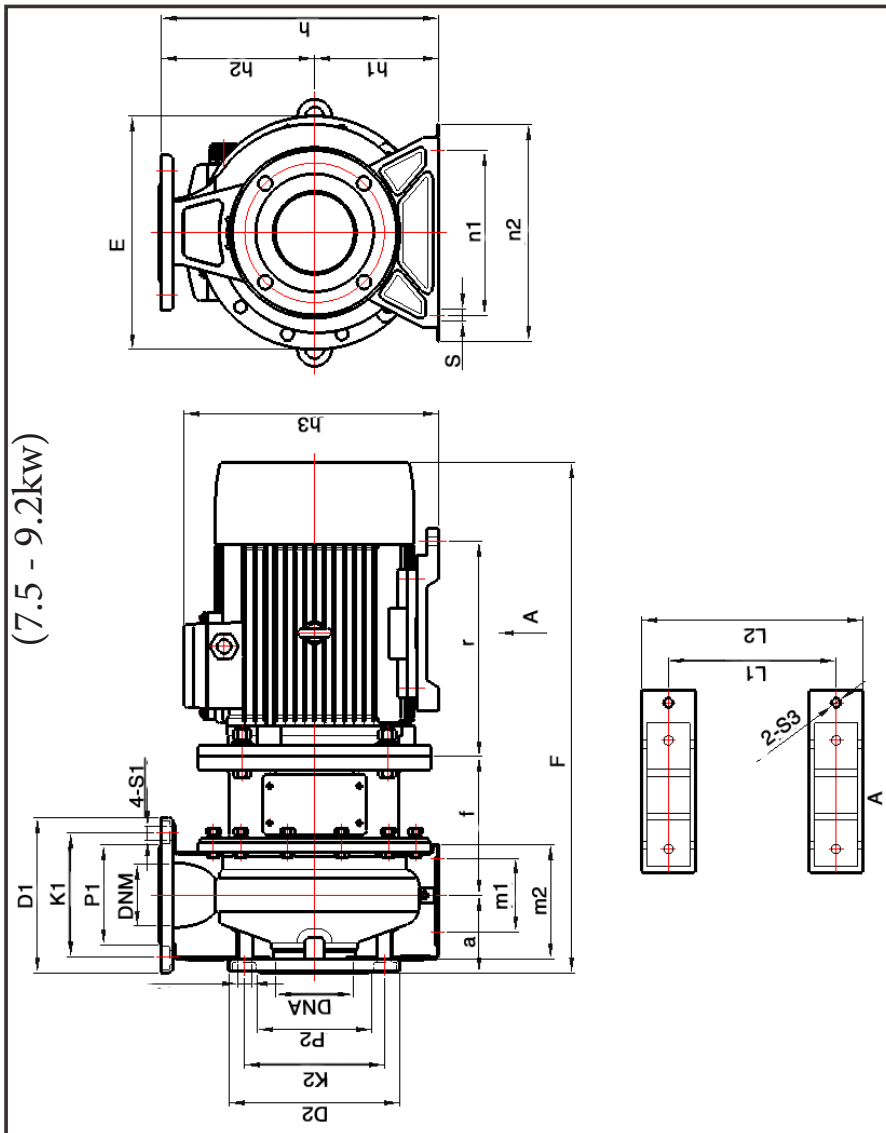

MODEL	Φ E	F	h	h1	h2	h3	a	m1	m2	n1	n2	S	L1	L2	L3	S3	r	f	D2	K2	P2	S2	n	D1	K1	P1	S1	DNA	DNM
80-65-125/7.5	245	644	340	160	180	327	100	95	155	212	280	15	216	286	/	12	278	165	220	180	152	18	4	200	160	132	18	80	65
80-65-160/5.5	300	644	340	160	180	327	100	70	150	212	265	15	216	286	/	12	278	165	220	180	152	18	4	200	160	132	18	80	65
80-65-160/7.5	300	644	340	160	180	327	100	70	150	212	265	15	216	286	/	12	278	165	220	152	132	18	4	200	160	132	18	80	65
80-65-160/9.2	301	658	360	160	180	327	100	95	155	212	280	15	216	286	/	12	278	165	220	152	132	18	4	200	160	132	18	80	65

Pump outline diagram & Dimensions

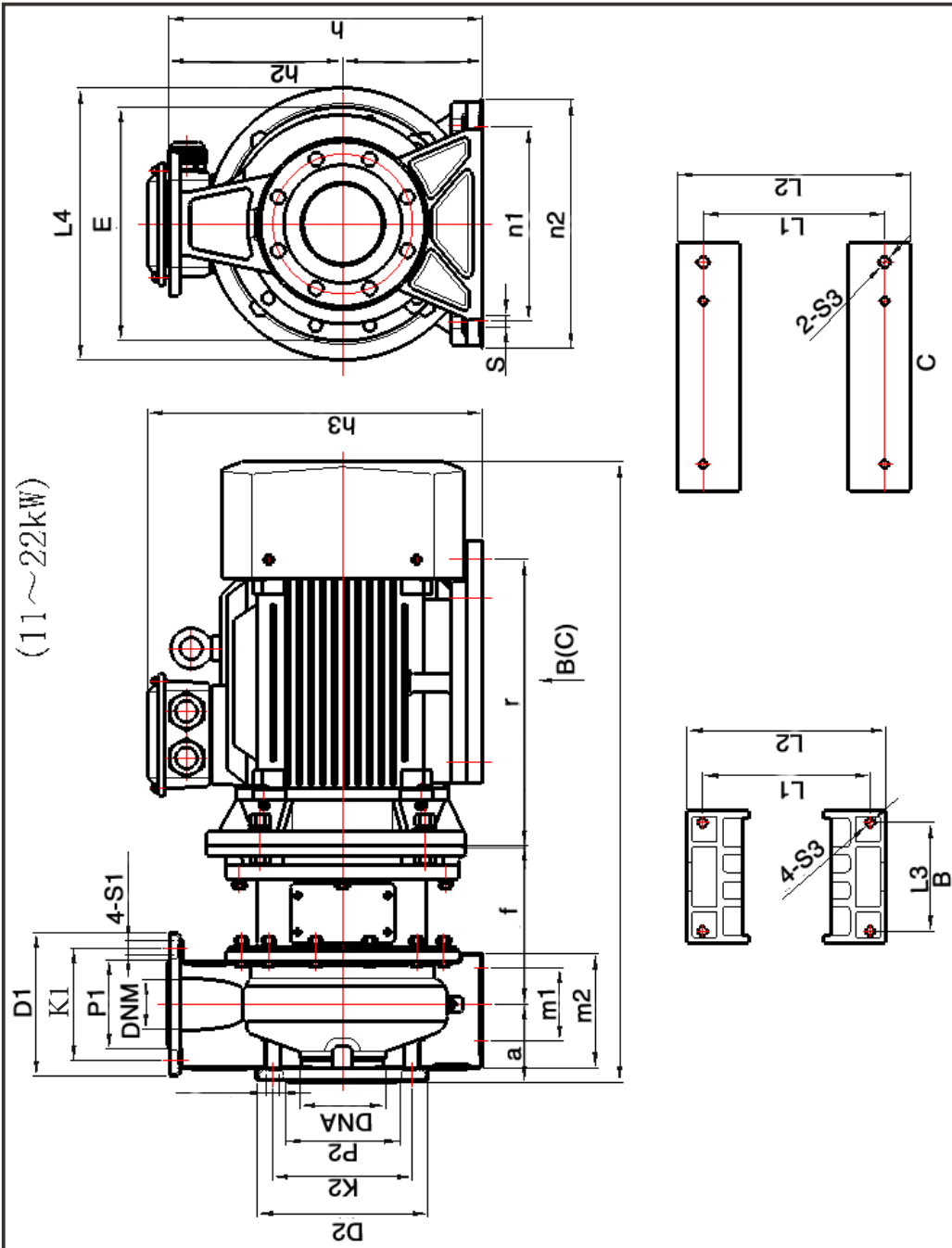

MODEL	ΦE	F	h	h1	h2	h3	a	m1	m2	n1	n2	S	L1	L2	L3	S3	r	f	D2	K2	P2	S2	n	D1	K1	P1	S1	DNA	DNM
80-65-160/11	301	840	405	180	225	432	100	95	155	250	320	15	254	348	/	15	368	150	220	180	152	18	8	200	160	132	18	80	65
80-65-200/15	301	840	405	180	225	432	100	95	155	250	320	15	254	348	/	15	368	205	220	180	152	18	8	200	160	132	18	80	65
80-65-200/18.5	301	840	405	180	225	432	100	95	155	250	320	15	254	348	/	15	368	205	220	180	152	18	8	200	160	132	18	80	65
80-65-200/22	301	840	405	180	225	432	100	95	155	250	320	15	254	348	/	15	368	205	220	180	152	18	8	200	160	132	18	80	65